

Turn on Hot model

1



2

Wait indicator turn green  
(2-4 min/Hot Model)

Place your photo into  
laminating pouch(A4-A6)

3

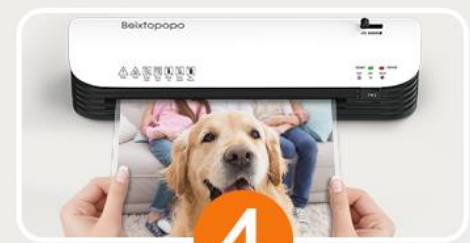

4

Insert the pouch into the inlet  
(Hot Model)

## A4 Laminator Machine Up To 230MM



21cm

29.7cm



14.8cm

21cm



10.8cm

14.8cm



7.4cm

10.8cm

## Hot lamination

- 1, Plug the power cord into an easily accessible standard electrical outlet.
- 2, Turn on the on / off switch on the right side of the device: "HOT", the red indicator lamp lights up
- 3, The drive motor for the transport rollers starts up. After about 3-4 minutes, the operating temperature is reached and the green indicator lamp lights up.
- 4, Place the laminated goods in the film bag so that there is a distance of around 2-6mm from the film edge on all sides.
- 5, Insert the film together with the laminate into the insertion slot of the laminator. The closed side of the film must be inserted first.

### DANGER

- \* Check whether the voltage specification of the device matches that of your electricity network. AC220-240V 50Hz (EU/UK/AU) AC100-120V 60Hz (US/JP)
- \* Use only hot lamination foils.
- \* To avoid folding the laminating film, the open side of the laminating film must never be inserted into the insertion slot of the laminator first. When inserting the film, please follow the instructions on the insertion slot. The lamination process is automatic.
- \* The emerging film is very hot and soft after lamination. Therefore handle the laminated product carefully.
- \* For leveling, the laminated product can be pressed with a book or other heavy, flat object.

## Cold lamination

- 1, Plug the power cord into an easily accessible standard electrical outlet.
- 2, Turn on the on / off switch on the top right side of the device: "COLD"
- 3, The drive motor for the transport rollers starts, the green indicator lamp lights up.
- 4, Remove the protective film from the film bag.
- 5, Place the laminated goods in the film bag so that there is a distance of about 2-3 mm from the film edge on all sides.
- 6, Insert the film together with the laminate into the insertion slot of the laminator. The closed side of the film must be inserted first.

### DANGER

- \* Check whether the voltage specification of the device matches that of your electricity network. AC220-240V 50Hz (EU/UK/AU) AC100-120V 60Hz (US/JP)
- \* If you used the laminator for hot lamination shortly before, you must let the laminator cool down. The cooling time takes up to 15 minutes.
- \* To avoid folding the laminating film, the open side of the laminating film must never be inserted into the insertion slot of the laminator first. When inserting the film, please follow the instructions on the insertion slot. The lamination process is automatic.



## Use of the laminating film

- ◆ Please select the correct size of the coated laminating film accordingly the document. The film size includes A4 (220x310 mm), A5 (225x160 mm) and hoto size (160x110 mm)
- ◆ Only use film bags of the correct size (max. Up to A4) and Thickness (80 to 125 mic \ 3-5mil (US). Too thin foil pockets can cause a blockage inside of the device.
- ◆ The laminating film has sealed on one side. Open the laminate and place the document to be laminated centrally in the film.
- ◆ Have the laminating film held 2-6mm away from the edge of the laminator.
- ◆ Please put the sealed laminating film side (not the open side) in the Entry to start lamination.

Figure 1 Sealed Edge



Figure 2

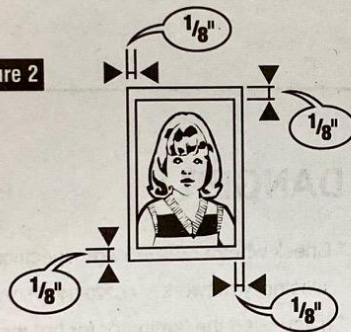

Figure 3

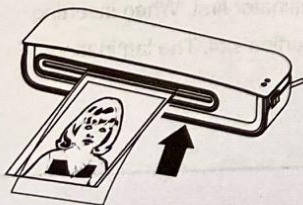
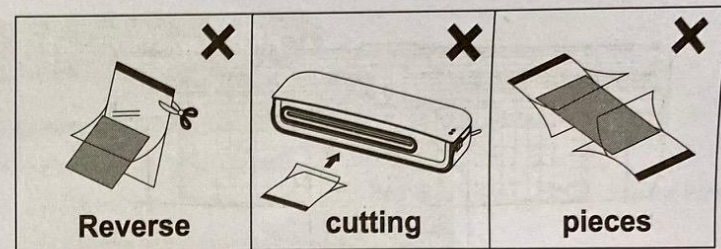

Figure 4



**⚠ Note:** Please avoid the following situations



## Using the paper cutter

*The laminator is equipped with a sharp and safe paper cutter, precise grid lines for effortless cutting. Cut documents, photos, images in any (desired) size.*

1. Open the transparent plate, place the document in the paper cutter, align the position and cover the transparent plate.
2. Fix the transparent plate and document with one hand, with the other hand hold the blade and pull or push it to the end.
3. Please clean the debris in the paper cutter before cutting again.

### DANGER

Pay attention to the cutting distance, too close to the edge of the document will destroy the laminating effect.

Move the blade to the center of the paper cutter, then use your fingers to open the transparent plate and take the blade out. Then replace the new blade. We usually don't recommend doing this, improper force can damage the paper cutter.



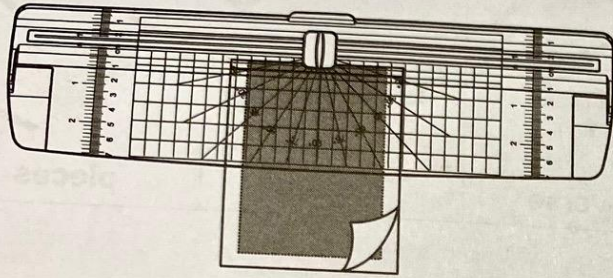

## Use of the corner rounder

*Evenly rounding the corners of documents, photos, pictures etc.*

1. Place the document in the corner filler and promptly push it down. You can take out the document when you hear the sound.
2. After use, you can remove the transparent cover on the bottom and clean crumbs.



## DANGER

Before use, you can check if there are crumbs on the back of the blade. If so, please remove it, otherwise it will affect the cut.

## Clear film jam

This laminator is equipped with the "ABS Jam Release" function  
To be able to quickly fix film jams.

1. If the film is blocked, switch off the device and use the "ABS" lever on the Press the right rear of the device to the left.
2. Hold the laminator firmly and pull the film together with the Laminate from the insertion slot of the laminator

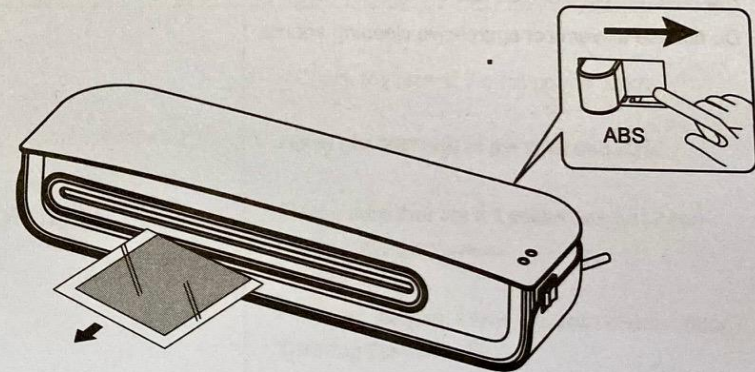

3. After that, the device will probably have to be repeated several times, as described under "Care and Cleaning", can be cleaned.
4. If the film jams are repeated or if the jam is no longer jammed can be pulled out of the laminator, please contact our hotline (see guarantee).